

Data Back up to One Drive and Data Sync

We have enabled one drive to sync the following folder.

1. Documents (C:\users\userprofile\Documents)
2. Desktop (C:\users\userprofile\Desktop)

The setting is policy enforced and cannot be disabled.

**But can be disabled if the user unlinks the account from one-drive settings. This will stop the backup and user will have to sign in again to complete the sync/backup.*

This would be seen as a policy violation.



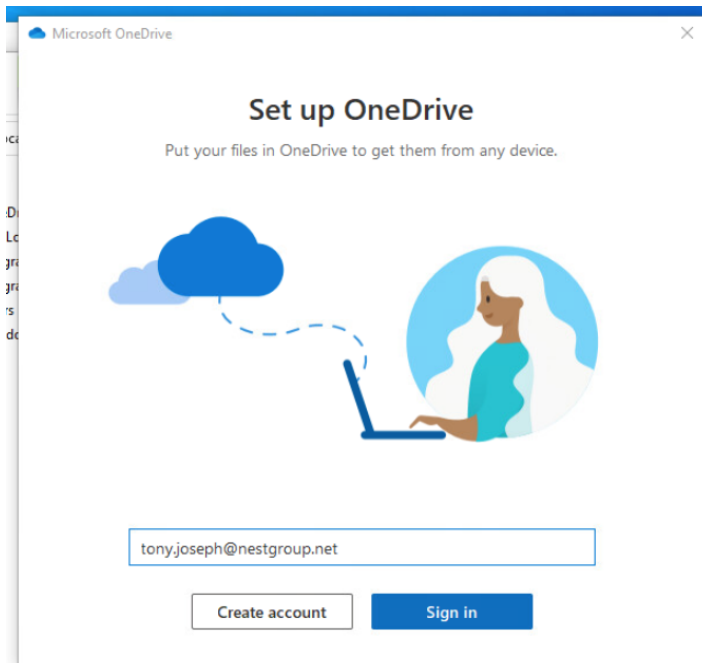

Type in the username and password.

Apart from the folders Documents and Desktop, the user will be prompted to select another folder.

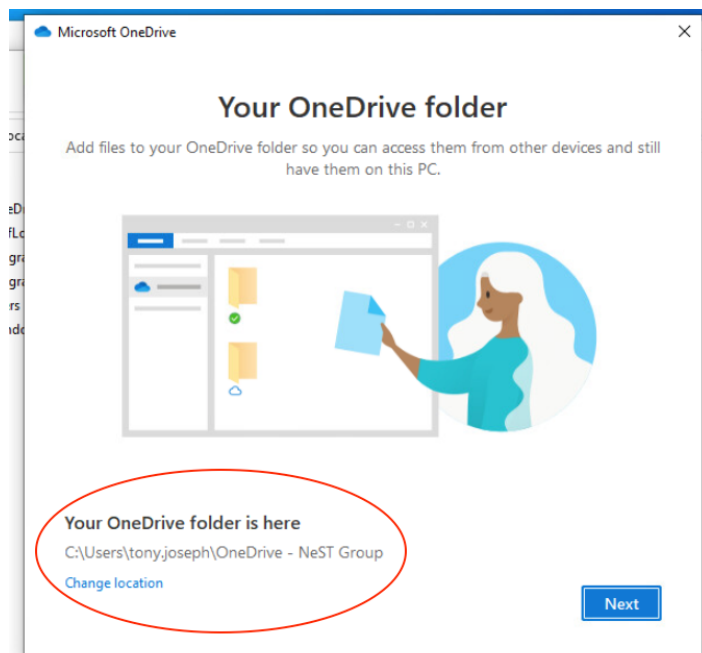

Select change location and navigate to the desired folder that need to be backed up.

If for some reason if you have selected the wrong folder, open one drive settings and select the option to unlink the pc.

